

TFT-LCD PIN FUNCTION

1 VSS	11 R6	21 B0	31 DISP
2 VSS	12 R7	22 B1	32 HSYNC
3 VDD	13 G0	23 B2	33 VSYNC
4 VDD	14 G1	24 B3	34 NC
5 R0	15 G2	25 B4	35 NC
6 R1	16 G3	26 B5	36 NC
7 R2	17 G4	27 B6	37 NC
8 R3	18 G5	28 B7	38 NC
9 R4	19 G6	29 VSS	39 LEDK
10 R5	20 G7	30 PCLK	40 LEDA

PCT PIN FUNCTION

1 GND	1 SCREEN SIZE
2 SDA	2 RESOLUTION
3 SCL	3 INTERFACE
4 VDD	4 DISPLAY MODE
5 INT	5 BRIGHTNESS
6 XRES	6 VIEWING DIRECTION
	7 VIEWING ANGLE(L/R/U/B)
	8 OPERATING TEMPERATURE
	9 STORAGE TEMPERATURE
	10 BACKLIGHT TYPE
	11 PCT

NOTE:

- : 4.3 inch
- : 480x272 Pixels
- : 24 Bit Parallel RGB
- : Normally Black
- : 610 cd/m<sup>2</sup> (Center TYP)
- : Full View Angle
- : 80°/80°/80°/80° (MIN)
- : -20°C ~ +70°C
- : -30°C ~ +80°C
- : LEDx10 (10S1P), V<sub>B</sub>=33V (TYP), I<sub>B</sub>=20mA
- : Five True Touch

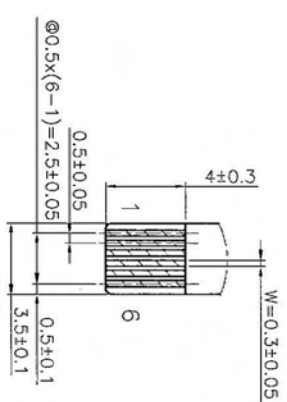
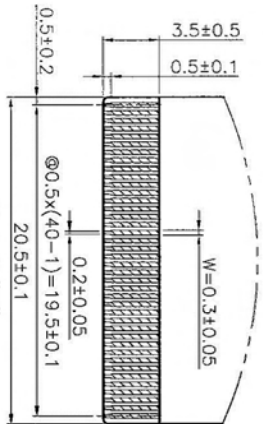
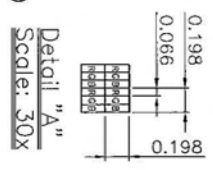

REVISION	1	INITIAL DRAWING	DESCRIPTION	REVISER	DATE	MATERIAL	DRAWING	CHECK	APPROVE	TOLERANCE:	DATE	MODEL	ASSEMBLY	REV.	UNIT	SCALE
	1			余宗穎	1/16'13	.X	余宗穎		朱宗穎	.X	1/16'13	LM430CT-MVA2	ASSEMBLY	1	mm	A4
	2									±0.5						
	3									±0.5						
	4									±0.5						
	5									±						
	6															

LANDMARK TECHNOLOGY, INC.

